

Precision Mount MXYZ-M18 for ZM18 lasers with M18 thread

The mount can be adjusted in 3 axes. No tools are necessary for alignment setup.

The base plate of the mount has 4 threaded holes, through which the mount can be installed. For best fixation of the laser, attaching a M18 nut in the front and rear is recommended.

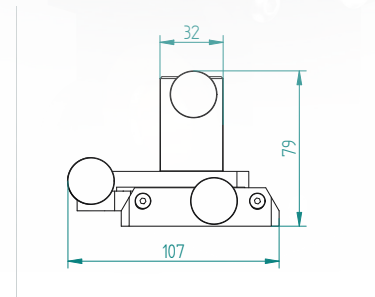
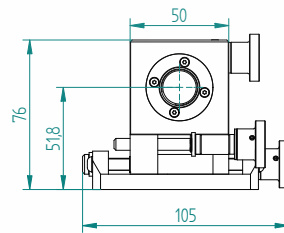
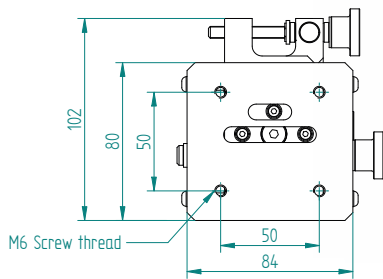
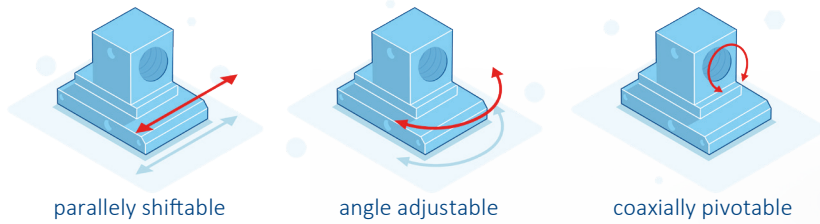

Highlights

- Aluminium mount for all ZM18 lasers
- parallely shiftable up to 20mm
- backlash-free self-locking
- coaxially pivotable, 360°
- maintenance-free
- angle adjustable up to 20°

General specifications

Housing	105mm x 107mm x 79mm (L, W, H)
Material	Anodised aluminium

Technical Data	Symbol	Unit	Min	Typ	Max
Length	l	mm	104,5	105	105,5
Width	w	mm	106,5	107	107,5
Height	h	mm	78,5	79	79,5
Axial Angle	α	°		360	
Parallel Adjustment	x	mm		+/- 9	
Tilting angle	ϕ	°		+/- 8	
Positioning accuracy angle		mrاد		0,5	
Positioning accuracy parallel		mm		0,1	
Positioning accuracy		mrاد		0,5	

DB1902