



## Mounting and Operating Manual

### Atmospheric Oxygen Sensor Element

# GOEL 370, GOEL 381



-  Please read these instructions carefully before use!
-  Please consider the safety instructions!
-  Please keep for future reference!



WEEE-Reg.-Nr. DE 93889386

## **Contents**

<b>1. SAFETY</b> .....	<b>2</b>
1.1. General note .....	2
1.2. Intended use .....	2
1.3. Skilled personnel.....	3
1.4. Safety signs and symbols .....	3
1.5. Reasonably foreseeable misuse.....	3
1.6. Safety guidelines .....	4
<b>2. PRODUCT DESCRIPTION</b> .....	<b>5</b>
2.1. Scope of supply .....	5
2.2. General information about application areas .....	5
2.3. General information about the oxygen sensors.....	6
<b>3. MOUNTING</b> .....	<b>7</b>
3.1. GOX 100.....	7
<b>4. DECOMMISSIONING, RESHIPMENT AND DISPOSAL</b> .....	<b>7</b>
4.1. Decommissioning .....	7
4.2. Reshipment and disposal.....	7
<b>5. SPECIFICATION (ALL SPECIFICATION BASIS ON ENVIRONMENT OF 25°C, 50 % R.H. AND 1013 HPA)</b> .....	<b>8</b>

## **1. Safety**

### **1.1. General note**

Read this document carefully and get used to the operation of the device before you use it. Keep this document within easy reach near the device for consulting in case of doubt.

Mounting, start-up, operating, maintenance and removing from operation must be done by qualified, specially trained staff that have carefully read and understood this manual before starting any work.

The manufacturer will assume no liability or warranty in case of usage for other purpose than the intended one, ignoring advices of this manual, operating by unqualified staff as well as unauthorized modifications to the device.

### **1.2. Intended use**

The sensor elements are suitable for the measuring of gaseous oxygen, in conjunction with appropriate devices (hand-helds, transducers).

**Dependent on the application, a suitable sensor-element must be chosen.**

See also the specification at the end of the document.

For the use in practice, the sensor element must be mounted in an applicable housing.

Personnel which starts up, operates and maintains the device has to have sufficient knowledge of the measuring procedure and the meaning of the resulting measured values, this manual delivers a valuable help for this. The instructions of the manual have to be understood, regarded and followed.

To be sure that there's no risk arising due to misinterpretation of measured values, the operator must have further knowledge in case of doubt - the user is liable for any harm/damage resulting from misinterpretation due to insufficient knowledge.

The manufacturer will assume no liability or warranty in case of usage for other purpose than the intended one, ignoring this manual, operating by unqualified staff as well as unauthorized modifications to the device.

### 1.3. Skilled personnel

Users of the readily installed device have to be sufficiently skilled in the operation of the device and able to avoid risks. The operator of the arrangement is responsible for sufficient qualification the operators.

### 1.4. Safety signs and symbols

Warnings are labelled in this document with the followings signs:

**Caution!**

This symbol warns of imminent danger, death, serious injuries and significant damage to property at non-observance.

**Attention!**

This symbol warns of possible dangers or dangerous situations which can provoke damage to the device or environment at non-observance.

**Note!**

This symbol point out processes which can indirectly influence operation, possibly cause incorrect measurement or provoke unforeseen reactions at non-observance.

**Caution, acid!**

This symbol warns of danger to living tissue and many materials, that can be damaged or destroy by exposure to that chemical.

### 1.5. Reasonably foreseeable misuse

1.



This device must not be used at potentially explosive areas!

Do not use these products as safety or emergency stop devices or in any other application where failure of the product could result in personal injury or material damage.

Failure to comply with these instructions could result in death or serious injury and material damage.

2.



This device must not be used at a patient for diagnostic or other medical purpose.

## 1.6. Safety guidelines

1. Faultless operation and reliability in operation of the measuring device can only be assured if the device is used within the climatic conditions specified in the chapter "Specifications".

2.  Sensors are not allowed to be used in „under-water-diving-application“ (e.g. Rebreather)

**DANGER**

3. When connecting the device to other devices the interconnection has to be designed most thoroughly, as internal connections in third-party devices (e.g. connection of ground with protective earth) may lead to undesired voltage potentials.

4.  The device must be switched off and must be marked against using again, in case of obvious malfunctions of the device which are e.g.:

**DANGER**

- Visible damage.
  - Device does not work like prescribed.
  - Storing the device under inappropriate conditions for longer time.
- When not sure, the device should be sent to the manufacturer for repairing or servicing.

5. Modifications or repairs of the device may not be performed by the customer.

6. If the device is transported from a cold to a warm environment condensation may result in a failure of the device. In such a case make sure the device temperature has adjusted to the ambient temperature before trying a new start-up.

7.  The sensor contains **KOH** (GOEL 381) or **acid** (GOEL 370).

KOH and acid can cause severe chemical burns!  
If leaking, avoid contact!

**If there was contact:**

- to skin: Flush contacted area with large amounts of water for several minutes.
- to clothing: remove contaminated clothing.
- to eyes: Flush with large amounts of water for several minutes, obtain medical treatment.

**After swallowing:**

- give large volumes of water. DO NOT induce vomiting!
- Obtain medical treatment

## 2. Product description

### 2.1. Scope of supply

- Oxygen sensor
- mounting and operating manual

### 2.2. General information about application areas

**GOEL 370 (acidic electrolyte):** Specialized sensor for diving application e.g. measuring Nitrox. Construction is optimized to this application, especially during professional usage in harsh environment the higher price will pay. Also suitable to measure oxygen-concentration in air or other gases with a high CO<sub>2</sub>-content or even in a CO<sub>2</sub>-atmosphere. The acid electrolyte guarantees that the sensor could not be influenced by CO<sub>2</sub>

**GOEL 380 (basic electrolyte):** Sensor for low oxygen concentration e.g. controlled atmosphere. Without larger CO<sub>2</sub> concentration \*)

**GOEL 381 (basic electrolyte):** Sensor for low oxygen concentration e.g. controlled atmosphere. Without larger CO<sub>2</sub> concentration \*)

\*)



The GOEL 381 and 380 (and formerly the GOEL 369) is designed to measure oxygen-concentration in air or other gases without larger CO<sub>2</sub> concentration. Higher CO<sub>2</sub>-concentration reduces the life-time of the sensor.

Short-time exposition of up to 10% CO<sub>2</sub> is not problematic (for example 15 minutes. up to 10 times per day) for the GOEL 380 (e.g. exhaust measuring). If there is measured more often with elevated CO<sub>2</sub>-concentration or at CO<sub>2</sub>-concentrations above 10%, the exposition time has to be kept as short as possible and sufficient measuring breaks should be made



If the sensor is not exposed to free air during measuring pauses, the connected tubes etc. have to be flushed with clean air or nitrogen.

## 2.3. General information about the oxygen sensors

**Lifetime:** At the end of life time the sensor signal drops relatively fast. The electrode evaluation in % therefore just can be used for orientation. An evaluation of 70% does not mean that 70% of life time are remaining, but 70% of the reference signal are available, which happens normally at the end of life time. The nominal life time can be shortened significantly by usage. Influencing factors are:

- Storage- / Operation temperature
- Humidity of measured gas: If permanently used with dry gases (technical gases, bottled gas) the life time decreases considerably.



The electrode evaluation is updated by the instrument every time, when the calibration of the sensor was performed successfully. (please also see the referring manual of the instrument)

**Operating position:** The optimum operation position is with the sensor inlet pointing downwards, maximum differential pressure to ambient is 250 mbar.

**Measuring precision:** The measuring precision can be influenced by:

- Liquids at the sensor inlet. Rinse the inlet and dry with lint-free cloth. Attention: avoid liquids of any kind at the contacts
- Gas and sensor temperature have to be at same level. Best precision, when calibrated at measuring temperature.
- Pressure fluctuations: The sensor is originally a partial pressure sensor, i.e. changes in the absolute pressure are influencing the measuring result directly proportional. A pressure change of 1% will cause a additional measuring error of 1%!  
For optimum precision calibrate at the same conditions at which You want to measure.

## 3. Mounting

The sensor housings are consisting of two halves (1) and (4) and can be opened by screwing up:

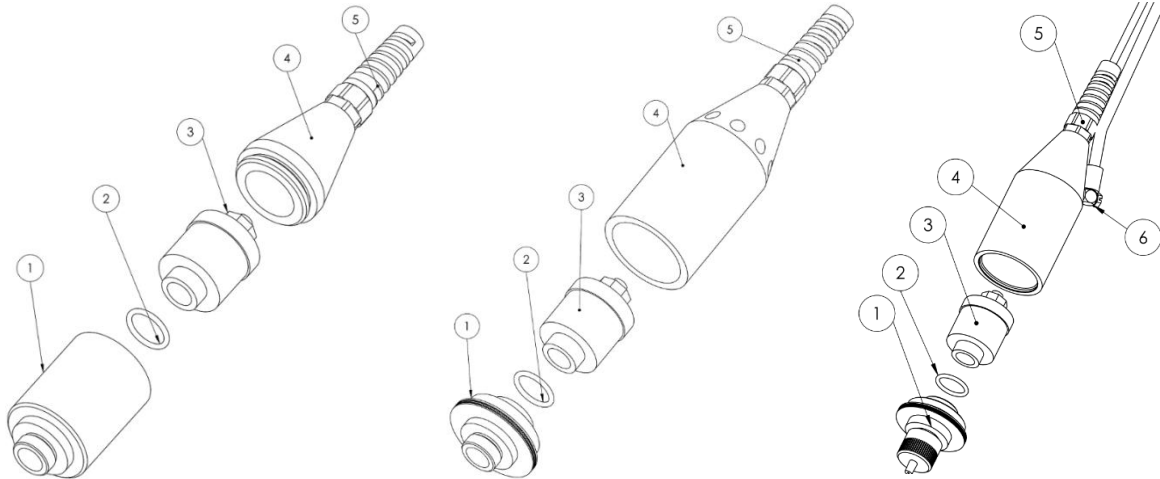

GGO/GGA housing

GOO housing

GOG / ResOx 5695 housing

Changeable part is the sensor element (3). Important when reassembling:

- First screw in sensor (3) in part (1). Do not forget O-Ring (2)  
Unscrew the sensor carefully e.g. by means of suitable nippers.
- The audio plug of part (4) has to be connected to the socket in the sensor. If this makes problems, the cable gland (5) can be opened so that the cable can be shifted further into part (4), until the plug can be connected.
- After that screw together (1) and (4) tightly, if necessary retighten the cable gland (5).



ATTENTION

**Attention:**  
**do not use force! Case can be destroyed by this!**

### 3.1. GOX 100

- disconnect the sensor connector
- open screw cap, memorize the positions of the rubber rings
- remove the sensor from case
- remove new sensor element from packing
- remove O-ring from new sensor (not needed)
- Place new sensor in case, considering the rubber rings
- Close screw cap, reconnect



## 4. Decommissioning, reshipment and disposal

### 4.1. Decommissioning

Please also make sure that connected Loads are disconnected also and are in a safe state.

### 4.2. Reshipment and disposal



DANGER

All devices returned to the manufacturer have to be free of any residual of measuring media and other hazardous substances.

Measuring residuals at housing or sensor may be a risk for persons or environment



Use an adequate transport package for reshipment, especially for fully functional devices. Please make sure that the device is protected in the package by enough packing materials.

Add the completed reshipment form of the GHM website  
<http://www.ghm-messtechnik.de/downloads/ghm-formulare.html>.



The device must not be disposed in the unsorted municipal waste! Send the device directly to us (sufficiently stamped), considering the above if it should be disposed. We will dispose the device appropriate and environmentally sound.

## 5. Specification (All specification basis on environment of 25°C, 50 % r.h. and 1013 hPa)

GHM sensor		GOEL 381	GOEL 370 (Rev 2)	Obsolete: GOEL 380
application		<b>Diving gas *1)</b> precise measuring at low O <sub>2</sub> (e.g. <0.5 % Vol. O <sub>2</sub> ) or concentrations above 35 % Vol. O <sub>2</sub>	<b>Diving gas *1)</b> Protection gases with CO <sub>2</sub> concentrations and O <sub>2</sub> concentrations below < 35% Vol. O <sub>2</sub>	Low oxygen concentration; Quick response
Permanent operation with high CO <sub>2</sub> -concentrations		-	+++	-
Short time exposition to CO <sub>2</sub> *2)		+	+++	+
Use up to 100% O <sub>2</sub>		+++	-	++
Use below 0,2% O <sub>2</sub>		+++	+	+++
Speed /t <sub>90</sub>		++ / <10s	++ / <10s	+++ < 5s
Lifetime hours per Vol. % O <sub>2</sub> , / at air		+/500 000 %h/ >2 years	++/1 200 000 %h/ max. 6 years	+/500 000 %h/ >2 years
Diving gas application *1)		+++	+++	+++
Meas. ranges	O <sub>2</sub> partial pressure	0 ... 1100 hPa	0 ... 350 hPa	0 ... 300 hPa
	O <sub>2</sub> concentration	0.0 ... 100.0 %	0.0 ... 35.0 % (lower accuracy above)	0.0 ... 25.0 %
Accuracy:		< 1.5 % @ 100 Vol. % O <sub>2</sub> , at 5 min meas. time	< 2 Vol. % ±0.02 Vol. %. < 35 Vol. % ± 0.5 % of measured value	
Electrolyte:		basic	acidic	
Storage temperature:		-15 to +60 °C		
Operating ambient		0 ... +45 °C		
Ambient pressure:		0.6 ... 1.75 bar abs.		
Over-/under pressure:		max. 0.25 bar ( <i>pressure difference sensor membrane to ambient – sensor screwed-in</i> )		
Material in contact media		PA, PPS, PTFE, stainless steel	ABS, PPS, PTFE, stainless steel, NBR	PA, PPS, PTFE, stainless steel
Cross sensitive		No to He, H <sub>2</sub> und CO	<20 ppm O <sub>2</sub> response to 100 % Vol. % CO , 100 % Vol. % CO <sub>2</sub> 100 % Vol. % C <sub>3</sub> H <sub>8</sub> 1000 ppm Benzene balance N <sub>2</sub> 3000 ppm NO <sub>2</sub> balance to N <sub>2</sub> 1000 ppm H <sub>2</sub> balance to N <sub>2</sub> 2000 ppm H <sub>2</sub> S balance to N <sub>2</sub> 1000 ppm SO <sub>2</sub> balance to N <sub>2</sub>	Signal von <0.1 % 15% CO <sub>2</sub> in N <sub>2</sub> , 10% CO in N <sub>2</sub> , 3000ppm NO in N <sub>2</sub> , 3000ppm C <sub>3</sub> H <sub>8</sub> in N <sub>2</sub> , 500ppm H <sub>2</sub> S in N <sub>2</sub> , 500ppm SO <sub>2</sub> in N <sub>2</sub> , 1000ppm Benzene in N <sub>2</sub>
Dimension		approx. Ø 30 x 44 mm Housing with M16 x 1-screw thread (sensor can be connected to line tubes by means of an additional adapter)		

\*1) Sensors are not allowed to use in „under-water-diving-application“ (e.g. Rebreather)

\*2) please refer chapter 2.2