

# Compression & Tension Load Cell

## >Model TX25

Model TX25 load cells measure both tension & compression load force. Applications include performance testers for automotive industry.

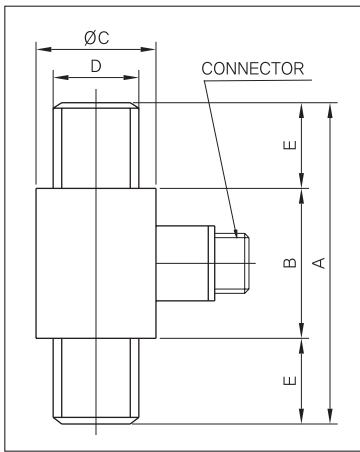

## >SPECIFICATIONS

Specifications	Accuracy
Rated capacity(R.C.)	100kgf~300tf (981N~2,942MN)
Rated output(R.O.)	1mV/V±1%
Nonlinearity	0.15% of R.O.
Hysteresis	0.15% of R.O.
Reperatability	0.1% of R.O.
Creep	0.05% of R.O.
Zero balance	±1% of R.O.
Excitation recommended	10V
Terminal resistance input, output	350Ω ±5%
Insulation resistance bridge	2000MΩ
Temperature range, compensated	-10~60°C
Temperature range, safe	-20~80°C
Temp. effect on rated output	±0.01% of LOAD/10°C
Temperature effect, on zero balance	±0.02% of R.O./10°C120%
Safe overload	R.C.
Cable length	Ø5 (1-2tf), Ø7 (10-300tf), 4core, 3m

## >DIMENSIONS TABLE

Model	Capacity	A	B	ØC	D	E	Weight(kg)
TX25-K100	100kgf (980.7N)	75	35	28	M16×1.5	20	0.5
TX25-K200	200kgf (1,961kN)	75	35	28	M16×1.5	20	
TX25-K500	500kgf (4,903kN)	75	35	28	M16×1.5	20	
TX25-T1	1tf (9,807kN)	75	35	28	M20×1.5	20	
TX25-T2	2tf (19,61kN)	75	35	28	M20×1.5	20	
TX25-T3	3tf (29,42kN)	75	35	28	M20×1.5	20	0.7
TX25-T5	5tf (49,03kN)	75	35	33	M24×2	20	
TX25-T10	10tf (98,07kN)	170	100	62.5	M39×2	35	2.5
TX25-T20	20tf (196,1kN)	190	100	63	M39×2	50	2.8
TX25-T50	50tf (490,3kN)	245	105	85	M64×2	70	7.5
TX25-T100	100tf (980,7kN)	340	140	115	M80×2	100	18
TX25-T200	200tf (1,961MN)	390	160	150	M110×2	115	36
TX25-T300	300tf (2,942MN)	450	194	169	M125×4	128	46

★Specifications are subject to change without notice.

## >Model TB

Tension & compression load force.

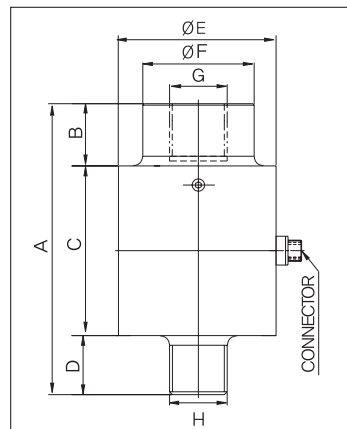
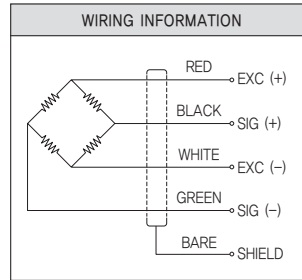
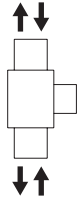

## >SPECIFICATIONS

Specifications	Accuracy
Rated capacity(R.C.)	1tf~300tf (9,807kN~2,942MN)
Rated output(R.O.)	1~20tf : 1mV/V±2%, 50~300tf : 1.5mV/V±2%
Nonlinearity	0.15% of R.O.
Hysteresis	0.15% of R.O.
Reperatability	0.15% of R.O.
Creep	0.05% of R.O.
Zero balance	±1% of R.O.
Excitation recommended	10V
Terminal resistance input, output	350Ω ±5%
Insulation resistance bridge	2000MΩ
Temperature range, compensated	-10~50°C
Temperature range, safe	-20~70°C
Temp. effect on rated output	±0.03% of LOAD/10°C
Temperature effect, on zero balance	±0.03% of R.O./10°C
Safe overload	120% R.C.
Cable length	Ø5 (1-2tf), Ø7 (5-300tf), 4core Shield Cable, 3m

## >DIMENSIONS TABLE

Model	Capacity	A	B	C	D	E	F	G	H	Weight(kg)
TB25-T1	1tf (9,807kN)	75	25.5	24.5	25	Ø30	Ø28	M20×1.5DP20	M20×1.5	2
TB25-T2	2tf (19,61kN)	75	25.5	24.5	25	Ø30	Ø28	M20×1.5DP20	M20×1.5	
TB25-T5	5tf (49,03kN)	173	30	100	43	Ø55.5	Ø42	M27×1.5DP40	M27×1.5	3
TB25-T10	10tf (98,07kN)	173	30	100	43	Ø62.5	Ø42	M27×1.5DP40	M27×1.5	
TB25-T20	20tf (196,1kN)	195	62.5	87.5	45	Ø62.5	Ø52	M33×2DP53	M33×2	5
TB25-T50	50tf (490,3kN)	295	50	190	55	Ø120	Ø78	M48×2DP55	M48×2	15
TB25-T100	100tf (980,7kN)	355	80	200	75	Ø176	Ø116	M72×6DP75	M72×6	35
TB25-T150	150tf (1,470MN)	385	125	170	90	Ø150	Ø130	M90×6DP90	M90×6	30
TB25-T200	200tf (1,961MN)	465	135	220	110	Ø190	Ø170	M110×6DP115	M110×6	58
TB25-T300	300tf (2,942MN)	496	143	200	153	Ø215	Ø185	M125×4DP125	M125×4	80