

# AD-1672A Tabletop Breeze Break with Inclined Front Beam Panel

## Instruction Manual

### 1. Features

- The tabletop breeze break protects the balance from breezes, due to air conditioning or body motion, thereby reducing balance weighing error.
- The transparent panel assembly consists of antistatic plastic material which protects the balance from static electricity.
- Two guides, in the back panel, can be used to pass the RS-232C and AC adapter cables through.
- Transfer of the tabletop breeze break is made easy due to its simple construction.

### 2. Specifications

- Mass: 10 kg
- Size: 680 (Width) x 600 (Depth) x 720 (Height) mm
- Materials: Transparent Panel: Antistatic vinyl chloride  
Frame: Aluminum

①	Back panel
②	Left side panel
③	Right side panel
④	Front beam panel
⑤	Ceiling panel

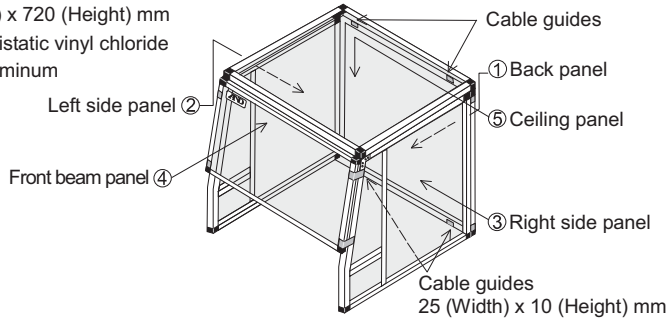

• Parts:

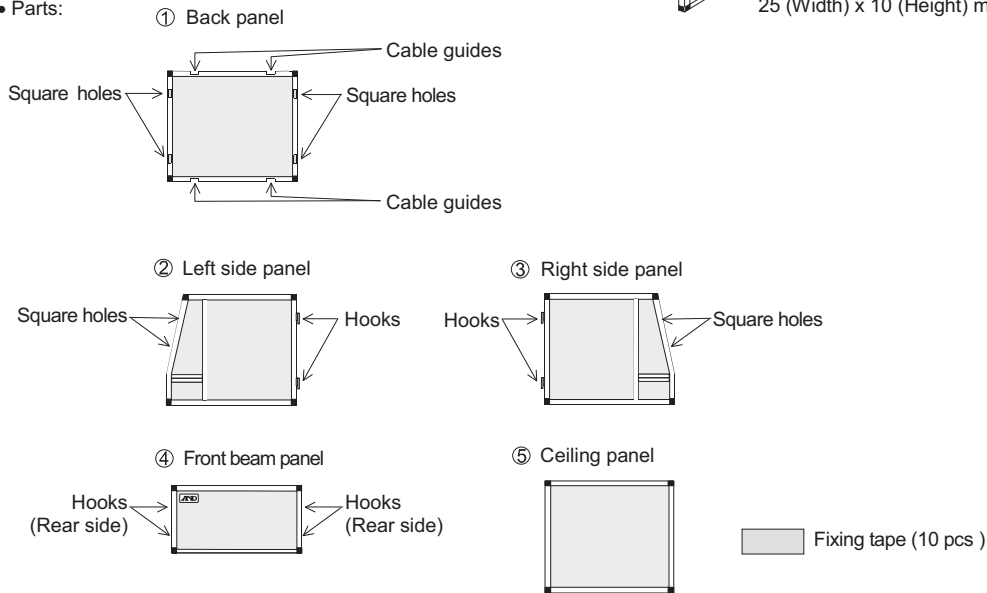

### 3. Assembling the Tabletop Breeze Break

Step 1. Place the back panel ① on the weighing table, with the label ① on top and the square holes on the front.

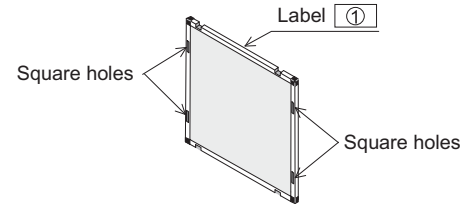

Step 2. Assemble the left side panel ② and the back panel ① using the hooks and the square holes.

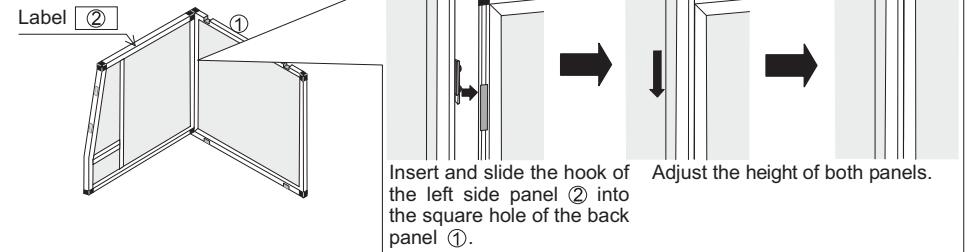

Step 3. Assemble the right side panel ③ in the same way as step 2.

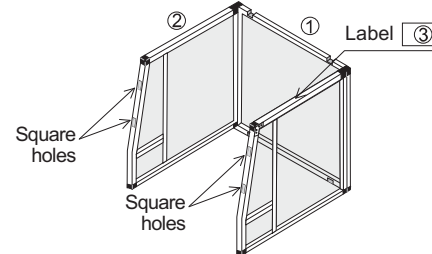

Step 4. Assemble the front beam panel ④ in the same way as steps 2 and 3.

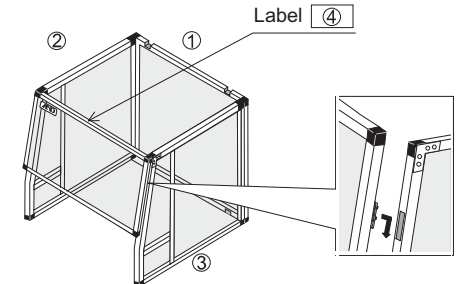

Step 5. Place the top panel ⑤ on.

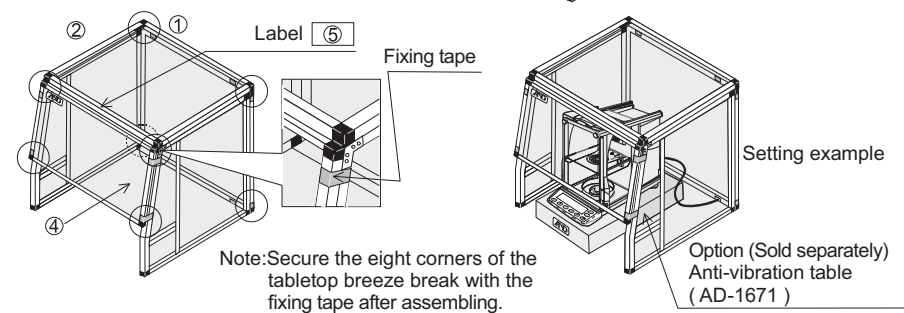

Caution

- Do not use organic solvents to clean the tabletop breeze break as that may damage the transparency and antistatic properties of the panels.
- Use a soft lint free cloth dampened with warm water and a mild detergent, when cleaning the tabletop breeze break.
- Do not modify the tabletop breeze break.
- When moving the assembled breeze break, exercise caution to keep the parts from becoming disconnected.